



✓
All values given in the table for the measuring force equal nominal values at electrical zero; max. deviation ± 25%. Valid for upright assembly position with downward oriented measuring bolt, as well as in static measuring.

Plastic sleeve marked with force related data

Shipping packaging



Accessories for TESA Probes

Spring Sets for Axial Probes

No	N
<i>Probes GT 22 and GTL 22</i>	
03260419	0,16
03260420	0,25
03260421	0,40
<i>Probes GT 21, GT 22, GTL 21, GTL 211, GTL 22 plus probe series 490 and 491</i>	
03260457	0,63
03260422	1,0
03260423	1,6
03260424	2,5
03260425	4,0

No	N
<i>Probes GT 27, GT 271 and GT 28</i>	
03260458	0,63
03260459	1,0
03260460	1,6
03260461	2,5
<i>Probes GT 61, GT 611 and GT 62</i>	
03260483	0,8
03260463	1,0
03260464	1,6
03260465	2,5



✓
Nitrile: resistant synthetic rubber for normal use.

Viton: high-resistance synthetic rubber used where probes are permanently exposed to cooling and lubricating agents.

Safety rings plus washer.

Shipping packaging

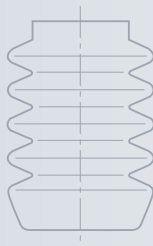

Spare Bellows for Axial Probes

Complete set with safety ring and washer

No		No	
<i>Probes GT 21, GT 22, GTL 21, GTL 211, GTL 22 plus probe series 490 and 491</i>		<i>Probes GT 27, GT 271, GT 28, GT 61, GT 611 plus probe series GT 62</i>	
03260468	Nitrile	03260491	Viton
03260470	Viton	<i>Probes GT 272, GT 282, GT 612, GT 622</i>	
<i>Probes GTL 212 and GTL 222</i>		03260490	Viton

Bellows supplied individually

<i>Probe series 410 and 451</i>		<i>Probes GT 43 and GT 44</i>	
19901024	Nitrile	028845	Nitrile
19901026	Viton	037608	Viton
<i>Probe series 430</i>			
19901027	Nitrile		
19901028	Viton		



✓
For high accuracy requirements, we recommend to adjust each part of your measuring equipment all together

Shipping packaging

Extension cable

No	m
03240201	1
03240202	2
03240203	3

Other cable lengths available on request

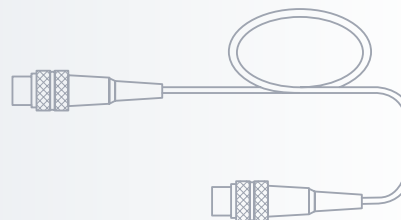

✓
Mounted between the probe and the electronic device

Shipping packaging

Attenuator Cable

No	Factor	m
03260415	1:2	0,3
03260416	1:3	0,3
03260417	1:√10	0,3
03260418	1:10	0,3

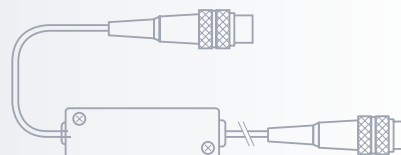

Clamping Elements for Axial Probes

Provided with 3 clamping faces – Prevent the metrology properties of the guiding system from being altered through the clamps.

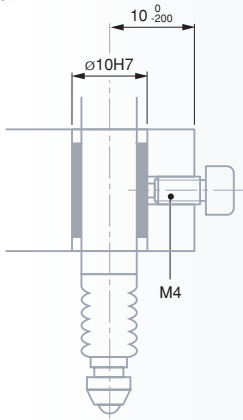

VKD clamp screw



02611013

M4

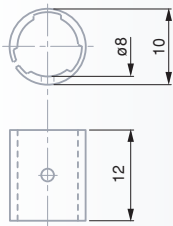
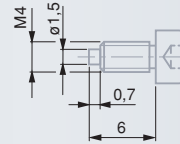

VKE clamp

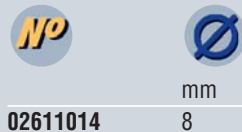

02611014

mm
8

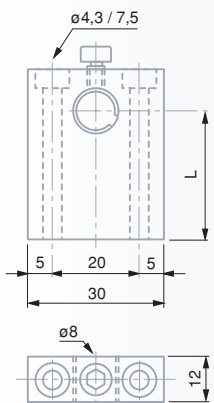

Clamp collar



01860401

Fastening points
mm
5,6 or 9,5 in diame-
ter with dovetail

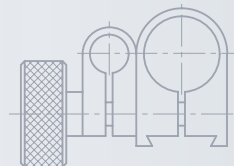

VDE clamps with fastening sleeve and screw included



02660048
02660049

mm
8
L mm
28
37

Manually Operated Devices for Retracting the Measuring Bolt

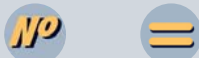
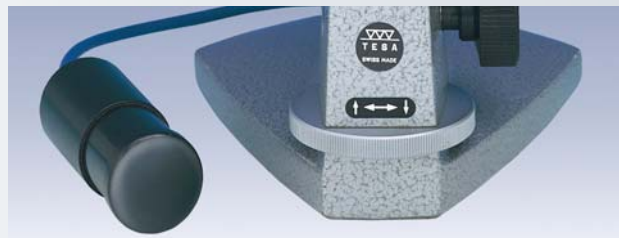

03540104 Mechanical retraction device

Consisting of:

03540101 1 Lift lever
03540102 1 Washer

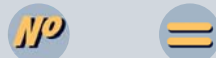

03260401 Pneumatic retraction device

Suited for probes GT 22, 271, 28, 42, 44, 611, 62 – GTL 211, 22 – 491

Consisting of:

03540405 1 Hand-operated vacuum pump
1 Air tube, 4,7 mm in diameter, 1 m long



All dimensions shown in the drawing must be respected



Shipping packaging



Shipping packaging



Hardened and ground steel

Shipping packaging

TESANORM Assembly Components

Small coordinate tables with accessories used for measuring centre-to-centre distances of bores or for similar applications – Mounted on roller-bearings for free move in one or two axes – Available in two sizes – Provided with probe holders among others.

- Model 42 x 42 mm with a 3 mm long travel, for bore diameters from 0,2 to 26 mm.
- Model 62 x 62 mm with a 6 mm long travel, for bore diameters from 26 to 100 mm.

Coordinate tables, 42 x 42 mm



02630001	VMA	Coordinate table for 1 axis, 3 mm long travel
02630005	VOA	Coordinate table for 2 axes, 3 mm long travel
02630003	VLA	Holder for centring heads
02660004	VQA	Centring head
02660005	VQB	Centring head
02660041	VUA	Holder for measuring heads

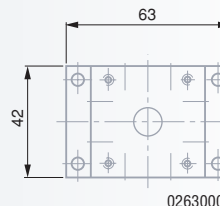
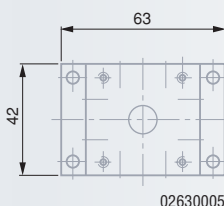
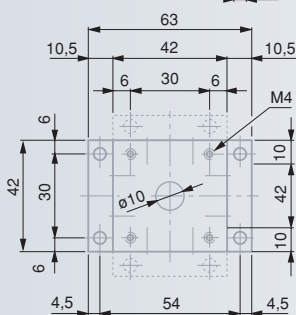
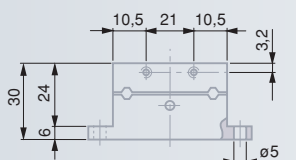

02630001

02630005

02630003

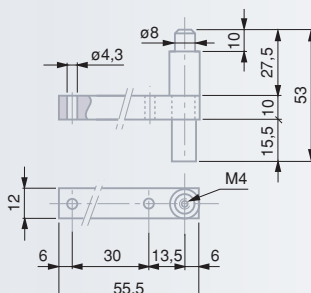
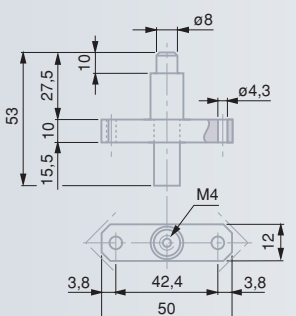

02660004

02660005

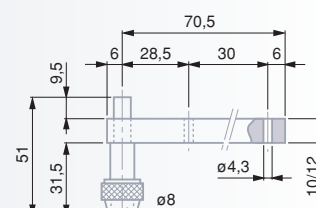

02660041

Coordinate table, 62 x 62 mm



02630002	VNA	Coordinate table for 1 axis, 6 mm long travel
02630006	VPA	Coordinate table for 2 axes, 6 mm long travel
02630004	VLB	Holder for centring heads
02660006	VRA	Centring head
02660007	VRB	Centring head
02660042	VUB	Holder for probing heads





Hardened and ground steel

Shipping packaging

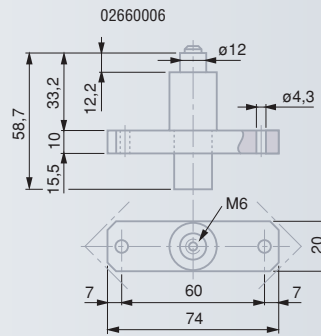
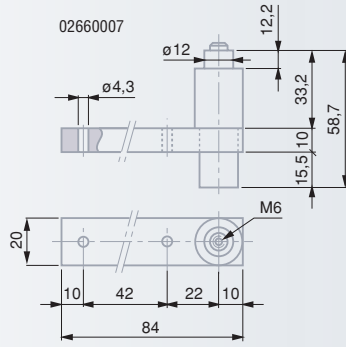
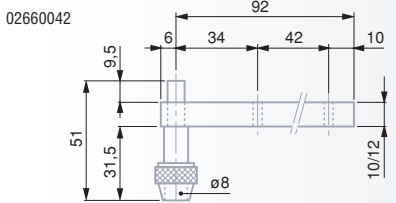
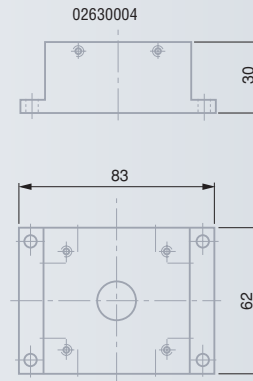
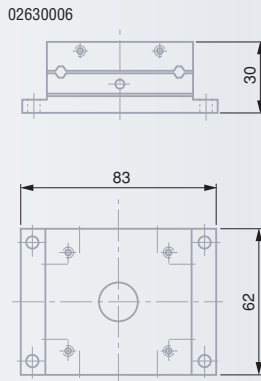
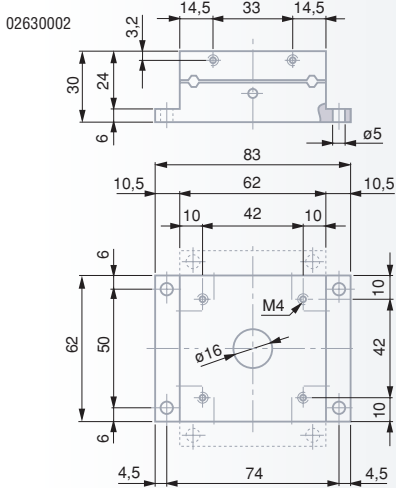

No	Symbol	mm
02660008	VSA	0,2 ÷ 0,7
02660009	VSB	0,7 ÷ 1,2
02660010	VSC	1,2 ÷ 1,7
02660011	VSD	1,7 ÷ 2,2
02660012	VSE	2,2 ÷ 2,7
02660013	VSF	2,7 ÷ 3,2
02660014	VSG	3,2 ÷ 3,7
02660015	VSH	3,7 ÷ 4,2
02660016	VSJ	4,2 ÷ 4,7
02660017	VSK	4,7 ÷ 5,2
02660018	VSL	5,2 ÷ 5,7
02660019	VSM	5,7 ÷ 6,2
02660020	VSN	6,2 ÷ 6,7
02660021	VSO	6,7 ÷ 7,2
02660022	VSP	7,2 ÷ 7,7
02660023	VSQ	7,7 ÷ 8,2
02660024	VSR	8,2 ÷ 8,7
02660025	VSS	8,7 ÷ 9,2
02660026	VST	9,2 ÷ 9,7
02660027	VSU	9,7 ÷ 10,2

No	Symbol	mm
02660028	VTA	10,2 ÷ 11,8
02660029	VTB	11,8 ÷ 14,2
02660030	VTC	14,2 ÷ 16,2
02660031	VTD	16,2 ÷ 18,2
02660032	VTE	18,2 ÷ 20,2
02660033	VTF	20,2 ÷ 22,2
02660034	VTG	22,2 ÷ 24,2
02660035	VTH	24,2 ÷ 26,2
02660036	VTJ	26,2 ÷ 28,2
02660037	VTK	28,2 ÷ 30,2
02660038	VTL	30,2 ÷ 32,2
02660039	VTM	32,2 ÷ 34,2
02660040	VTN	34,2 ÷ 36,2
02660050	VTO	36,2 ÷ 38,2
02660051	VTP	38,2 ÷ 40,2
02660052	VTQ	40,2 ÷ 42,2
02660053	VTR	42,2 ÷ 44,2
02660054	VTS	44,2 ÷ 46,2
02660055	VTT	46,2 ÷ 48,2
02660056	VTU	48,2 ÷ 50,2

No	Symbol	mm	Description
02630016	VDA		Probe holder
02630017	VDB		Probe holder
02630018	VDC		Probe holder
02660047	VDD		Probe holder
02660048	VDE	28	Probe holder
02660049		37	
02660044	VFB		Spring clamp
02611010	VKF	29	Spring
02611011		45	
02611001	VKA	50	Rods
02611002		75	
02611003		100	
02611004		125	
02611005		150	
02611006		175	
02611007		200	
02630020	VEB	35	Stops
02630021		60	
02630022		110	
02630023		160	

02660008/17

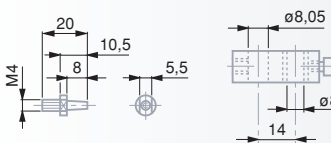

02660018/27

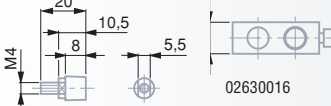

02630016

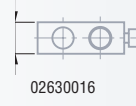

02630017

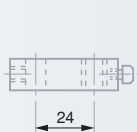

02630018

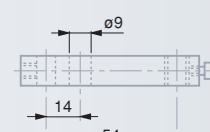

02660047

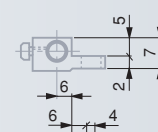

02660028/56

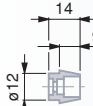

02660044

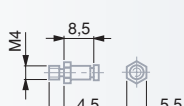

02611001/7

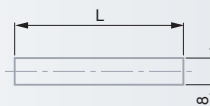

02611010/11



02630020/23



02660048/49

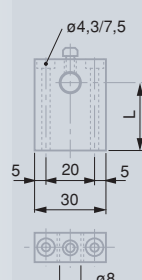



✓
Suited for 20 probes GT 22, 42 and 44 series or max. 10 probes GT 28 and 62.

230 V, 50 Hz



Shipping packaging



✓
230 ± 10% V, switchable to 115 ± 10% V

Needed pressure: 1 to 7 bars

190 x 170 x 310 mm

3,5 kg



Shipping packaging

Electropneumatic Systems for Activating the Measuring Bolt

Electropneumatic vacuum pump

For lifting up to 20 measuring bolts simultaneously with a measuring force up to 0,63 N



03260431 Operated via the built-in push-button or 24 V relay

03260432 Operated via the mains powered foot switch



FMS-C electropneumatic vacuum pump

Uses vacuum or air pressure; allows simultaneous connection of up to 30 TESA probes. Ideal for use with FMS probes with parallel guiding.



03260486 Controlled electrically through a TESA's electronic unit or manually

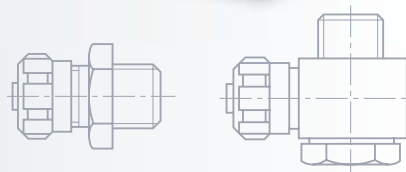
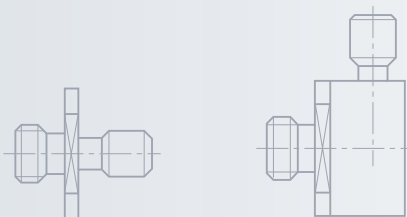

Air tube connectors for TESA probes GT 22, 271, 28, 42, 44, 611, 62 – GTL 211, 22 – 491

M4 coupling threads; suited for a 4,7 / 2 mm dia. air pipe (No. 03540405)



Connector type

03560000 straight

03560002 angled

Air tube connectors for TESA FMS probes

M5 coupling threads; suited for a 4,7 / 2 mm dia. air pipe (No. 03540405)



Connector type

026522 straight

024388 angled

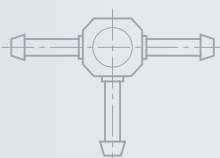

Connecting T-piece



03540403 For air pipe diameter Ø 4,7 / Ø 2 mm (N° 03540405)

Vacuum release delay valve

For controlling the lowering speed of axial probes



03540404 For air pipe diameter Ø 4,7 / Ø 2 mm (N° 03540405)

