



DIN 874 T2  
NF E 11-104

Hardened steel to  
≥ 650 HV 10

Models with length  
up to 200 mm in a  
plastic bag.  
Models from 300 mm in a  
wooden case.

Declaration  
of conformity

## ROCH Bevelled Straight Edges

Provided with 1 bevelled edge – Also with Heat insulating handle.

|            | mm  | µm |
|------------|-----|----|
| 0951750002 | 75  | 2  |
| 0951750003 | 100 | 2  |
| 0951750004 | 125 | 3  |
| 0951750005 | 150 | 3  |
| 0951750006 | 200 | 3  |
| 0951750007 | 300 | 3  |
| 0951750008 | 400 | 4  |
| 0951750009 | 500 | 4  |
| 0951750010 | 600 | 5  |
| 0951750011 | 750 | 5  |

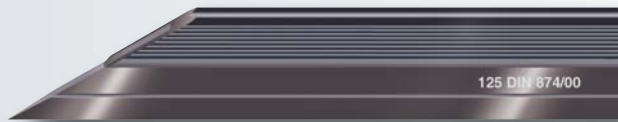

Factory  
standard

Stainless steel  
to 200 HRB  
(not tempered)  
or ≥ 550 HV 30 (tempered)

Accuracy class  
0 or 1

Suited  
carrying case

Declaration  
of conformity

## ROCH Flat and Try Squares

Made from stainless steel

Accuracy class 0, not tempered

|                         |                        | Length<br>of beams<br>mm | Section<br>mm | µm |
|-------------------------|------------------------|--------------------------|---------------|----|
| <i>90° flat squares</i> | <i>90° try squares</i> |                          |               |    |
| 0951751584              | 0951751624             | 75 x 50                  | 15 x 5        | 7  |
| 0951751585              | 0951751625             | 100 x 70                 | 20 x 5        | 7  |
| 0951751587              | 0951751627             | 150 x 100                | 28 x 6        | 8  |
| 0951751588              | 0951751628             | 200 x 130                | 32 x 7        | 9  |
| 0951751589              | 0951751629             | 250 x 165                | 35 x 8        | 10 |

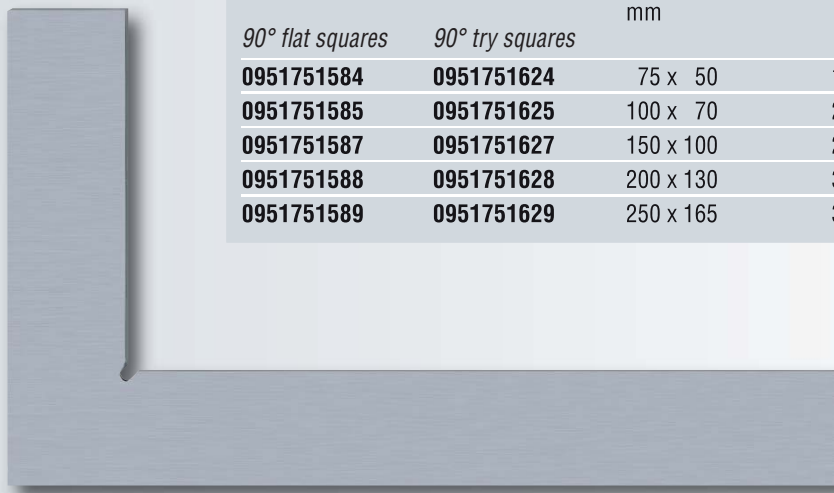

## Accuracy class 0, tempered

|                         |                        |                    | Flat squares section of beams mm | Try squares section long beam mm | Try squares section short beam mm |    |
|-------------------------|------------------------|--------------------|----------------------------------|----------------------------------|-----------------------------------|----|
| <i>90° flat squares</i> | <i>90° try squares</i> | Length of beams mm |                                  |                                  |                                   |    |
| <b>0951751523</b>       | <b>0951751543</b>      | 50 x 40            | 15 x 4                           | 16 x 2                           | 14 x 10                           | 7  |
| <b>0951751524</b>       | <b>0951751544</b>      | 75 x 50            | 15 x 4                           | 18 x 2                           | 14 x 10                           | 7  |
| <b>0951751525</b>       | <b>0951751545</b>      | 100 x 70           | 20 x 5                           | 18 x 2                           | 16 x 10                           | 7  |
| <b>0951751527</b>       | <b>0951751547</b>      | 150 x 100          | 30 x 6                           | 22 x 2                           | 20 x 12                           | 8  |
| <b>0951751528</b>       | <b>0951751548</b>      | 200 x 130          | 30 x 7                           | 26 x 3                           | 24 x 14                           | 9  |
| <b>0951751530</b>       | <b>0951751550</b>      | 300 x 200          | 40 x 8                           | 32 x 3                           | 30 x 18                           | 11 |

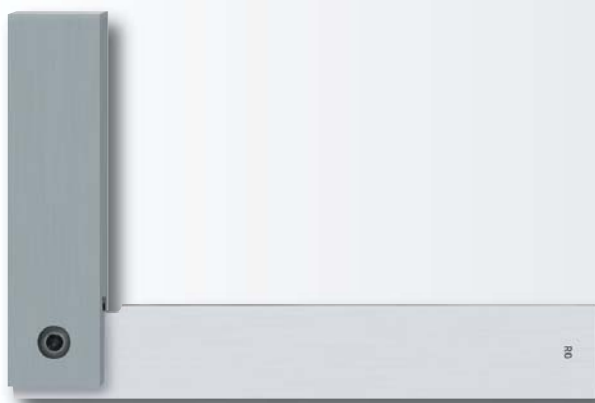

## Accuracy class 1, not tempered

|                         |                        |                    | Section mm |    |
|-------------------------|------------------------|--------------------|------------|----|
| <i>90° flat squares</i> | <i>90° try squares</i> | Length of beams mm |            |    |
| <b>0951751564</b>       | <b>0951751604</b>      | 75 x 50            | 15 x 5     | 14 |
| <b>0951751565</b>       | <b>0951751605</b>      | 100 x 70           | 20 x 5     | 15 |
| <b>0951751567</b>       | <b>0951751607</b>      | 150 x 100          | 28 x 6     | 18 |
| <b>0951751568</b>       | <b>0951751608</b>      | 200 x 130          | 32 x 7     | 20 |
| <b>0951751569</b>       | <b>0951751609</b>      | 250 x 165          | 35 x 8     | 23 |
| <b>0951751570</b>       | <b>0951751610</b>      | 300 x 200          | 40 x 8     | 25 |
| <b>0951751572</b>       | <b>0951751612</b>      | 500 x 330          | 50 x 10    | 35 |
| <b>0951751574</b>       | <b>0951751614</b>      | 750 x 500          | 60 x 12    | 43 |
| <b>0951751575</b>       | <b>0951751615</b>      | 1000 x 660         | 70 x 14    | 60 |

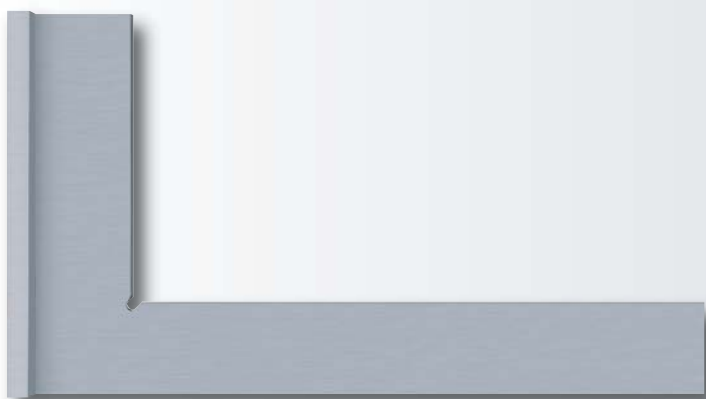



Factory standard

Hardened steel

Suited plastic case

## Brown & Sharpe Try Square Set



06739001

Brown & Sharpe Try Square Set



mm

µm

Consisting of:

|              |          |    |
|--------------|----------|----|
| 1 Try square | 68 x 45  | 16 |
| 1 Try square | 120 x 70 | 16 |
| 1 Try square | 175 x 95 | 16 |



DIN 875  
NFE 11-103

Stainless steel  
hardened to  
≥ 550 HV 30



Accuracy  
class 00



Suited  
carrying case



Declaration  
of conformity



## ROCH Bevelled Edge Squares

Made from stainless steel, hardened



Length of  
beams  
mm

Flat squares  
Section  
of beams  
mm

Try squares  
Section  
long beam  
mm

short beam  
mm



µm

90°  
flat squares

90°  
try squares

|                   |                   |           |          |        |         |   |
|-------------------|-------------------|-----------|----------|--------|---------|---|
| <b>0951751533</b> | <b>0951751553</b> | 50 x 40   | 14 x 4,5 | 16 x 2 | 14 x 10 | 3 |
| <b>0951751534</b> | <b>0951751554</b> | 75 x 50   | 16 x 4   | 18 x 2 | 14 x 10 | 3 |
| <b>0951751535</b> | <b>0951751555</b> | 100 x 70  | 20 x 5   | 18 x 2 | 16 x 10 | 3 |
| <b>0951751537</b> | <b>0951751557</b> | 150 x 100 | 28 x 6   | 22 x 2 | 20 x 12 | 4 |
| <b>0951751538</b> | <b>0951751558</b> | 200 x 130 | 30 x 7   | 26 x 3 | 24 x 14 | 4 |
|                   | <b>0951751560</b> | 300 x 200 | 40 x 8   | 32 x 3 | 30 x 18 | 5 |

